

BRANDMEISTER SPECIAL

Artem R3ABM
HamRadio 2018

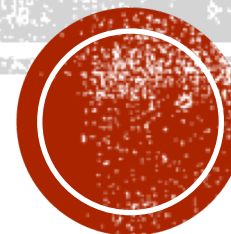

IP-connected TERMINALS (PoC)



Hytera PDC760



PDC760 IP-CONNECTED MODE

- **LTE/3G or Wi-Fi bearer**
- Private and Group calls over IP
- Private SMS over IP
- Manual switching between Conventional and Trunking + RoIP
- RoIP settings are only available at Trunking part of codeplug

Link Name	Link Type	ID	Caption	State	Specific Values	Interpretation
HyteraPTT RoIP	Terminal	2503001	-	-	1, 1913487701, 28049107, 0, 234806157, 0, 4, 2501, 0, 0, 0, 3161302120, 0, 0, 0, 0, 0, 0, 0	Idle
					000 0 0 0 0 0 0 0 0 0 0 0 0 0 0 0 0	5 0 0 0 0 0



NEW USER EXPERIENCE

- Group subscriptions are fully managed by the radio's codeplug and UI
- Automatic mode
 - Deliveries all incoming private calls
 - Deliveries all group call subscribed by terminal
 - Selected talk group at Subgroup list of codeplug
 - Any talk group of ACK/Background list of codeplug
- Exclusive mode
 - Just select or dial contact from the contact list
 - It is like a normal phone call by with PTT
 - Only particular contact calls will be delivered



CONNECTING AND MANAGE CHANNELS

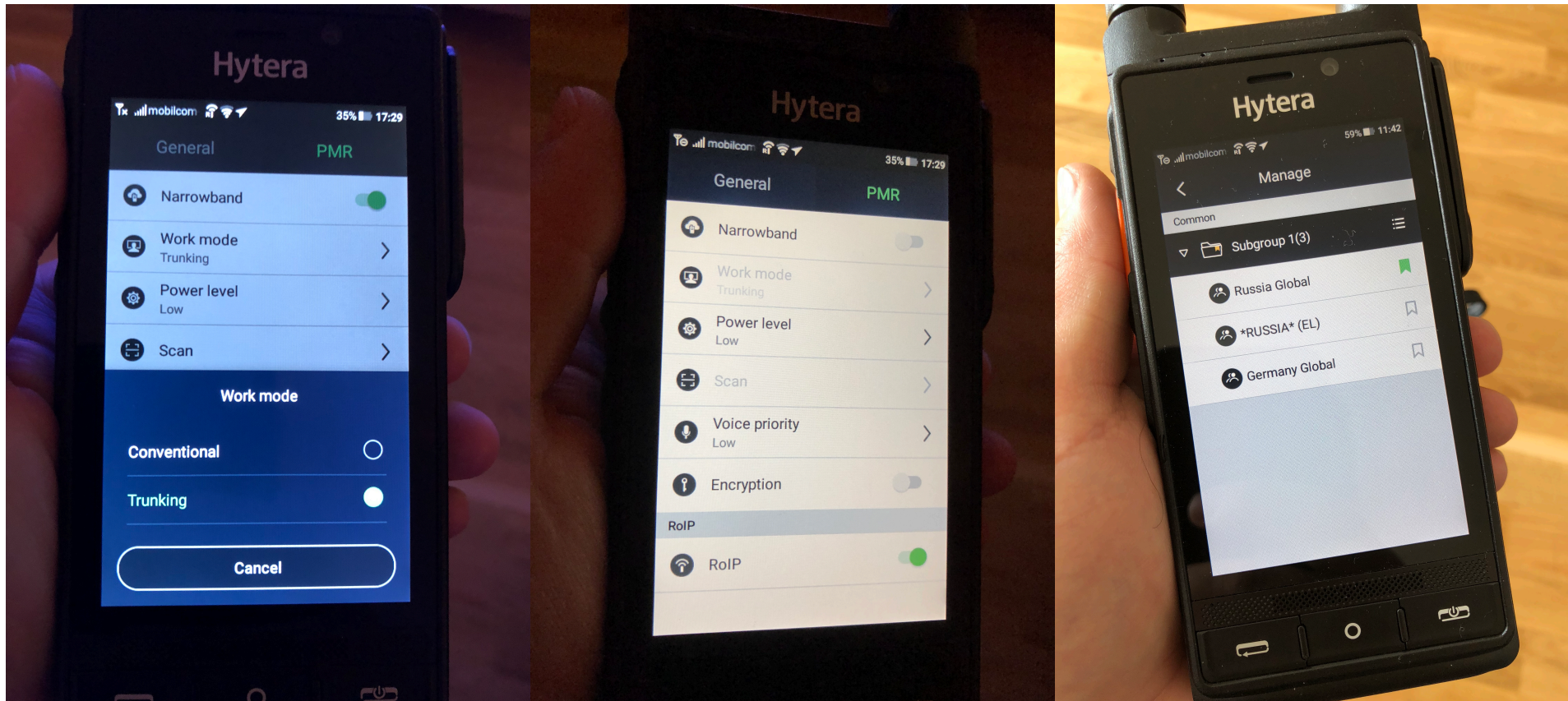

AUTOMATIC MODE

- Fully corresponds to conventional DMR



EXCLUSIVE MODE

- Private or group ID
- Use hang-up button to exit
- Contact can be selected
 - From contacts
 - Entered manually
- Entered group
 - Will stay available in Automatic mode for 90 secs



TEXT MESSAGING

- Seamless between DMR and PoC
- Private SMS only

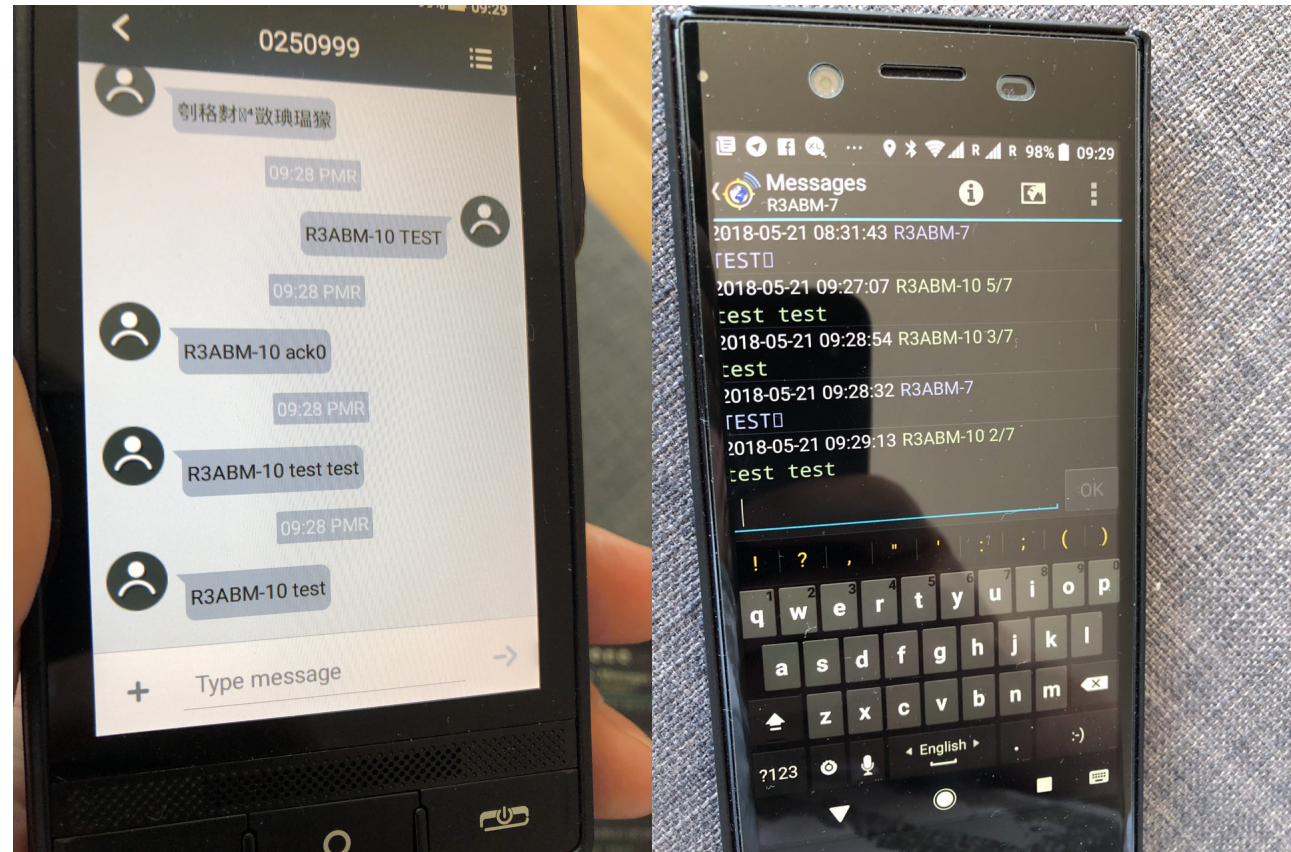

CODEPLUG • GENERAL

- Trunking section corresponds to RoIP
- You have to configure ID, contacts and groups second time at Trunking
- Don't forget to configure TSCC to use amateur band frequency
- Use DMR Flat dial rule at Dial Settings



CODEPLUG • ROIP CONNECTION

Edit Public Parameter

Model Name: PDC760 UxB1(DMR 350-527MHz GPS only) Configuration: V1.5.09.000

Parameter Name Search Broadband/RoIP Connection Import Export

Wireless and Network

APN List

MDM Address

Log

Menu Control

RoIP Connection

System Upgrade

BT White List

IPTable

User Name your DMR ID

RoIP ID your DMR ID

Password hotspot password

Server Address server address

Server Port 50180

Time Out Time(ms) 0

Save Program Cancel



**Available
today**



BACKLOG

- PoC GPS as a normal BrandMeister service
- New status page and REST service with extended information
- Support of other IP-connected terminals (AMBE support required)

